

Rectifier Module
18VDC / 1125A Output

BREC-18

Product Features:

- Power Rectifier for Ballast Water Treatment
- Wide-Range Input Voltage (3 ϕ , 375VAC ~ 510VAC)
- Compact, Modular Design (easy module replacement)
- High Power Density; Water-Cooled Design
- Parallel Connection, up to 8 modules
- Output Current & Voltage Control Modes
- Soft start for safe, energy-efficient operation
- LED Alarm Indicators
- Constant Electric Power Control



Input Specifications:

VOLTAGE	3 ϕ 440VAC (374VAC ~ 510VAC)
FREQUENCY	47-63Hz
INRUSH	50A @ 440VAC per Module
CURRENT	30A @ 440VAC(Max Continuous) per Module
PROTECTION	UVP, OVP, IGBT Ic P/T, A Fuse per phase
LEAKAGE	3.5mA Max @ 440VAC per Module
EFFICIENCY	Over 85%
HARMONICS	EN61000-3-2 Class D Compliant (>90PF)
PROTECTION	Input Undervoltage, Overvoltage

General Specifications:

OPERATING TEMP	0 $^{\circ}$ C to +55 $^{\circ}$ C
STORAGE TEMP	-25 $^{\circ}$ C to +75 $^{\circ}$ C
WATER TEMP	0 $^{\circ}$ C to +40 $^{\circ}$ C
OPERATING HUMIDITY	10% to 95% (Non-Condensing)
STORAGE HUMIDITY	5% to 95% (Non-Condensing)
COOLING	Cooling Water
VIBRATION	2-100Hz, 0.7G, 120min period each(3 axes)
RELIABILITY	150,000 Hrs MTBF
ALTITUDE	0~10,000 Feet
SIZE(W \times D \times H)	390 \times 356 \times 250mm(Module)

Output Specifications:

Vout	18VDCmax
Iout	1125ADC (1300A at 15VDC)
ADJUSTMENT RANGE	1VDC~18VDC
LINE REGULATION	\pm 2% Max over entire input range
LOAD REGULATION	\pm 2% Maximum
TEMP REGULATION	\pm 2% Maximum
SETPOINT ACCURACY	\pm 0.5%
OVER CURRENT	105~120%
OVER VOLTAGE	19VDC(recycle input to reset)
PROTECTION	Thermal Shutdown

Electromagnetic Compatibility:

EMISSIONS	CISPR 16-1,16-2
ELECTROSTATIC DISCHARGE	IEC61000-4-6
RADIATED SUSCEPTIBILITY	
EFT/BURSTS	IEC61000-4-4 LEVEL 3
SURGE	
CONDUCTED IMMUNITY	IEC61000-4-5 LEVEL 2
VOLTAGE DIPS	IEC61000-4-6 LEVEL 2
VOLTAGE INTERRUPTIONS	IEC61000-2 LEVEL 3

Status & Control signals:

CURRENT SHARE <10% of nominal current



Rectifier Module
18VDC / 1125A Output

BREC-18 Module

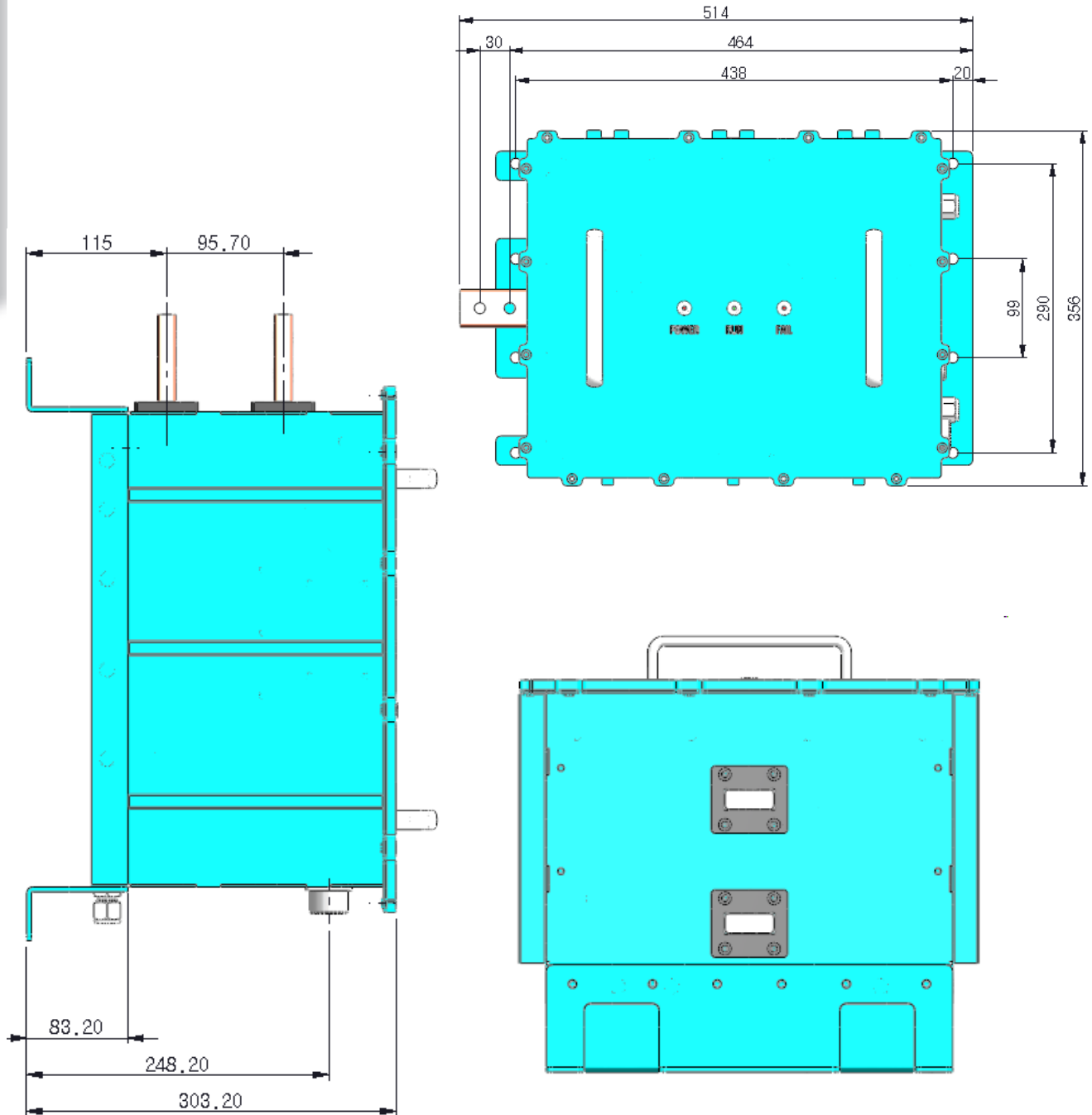

BREC-18 1Set

Rectifier Module
18VDC / 1125A Output

